

The Unico System[®]

Small-Duct Central Heating & Air Conditioning

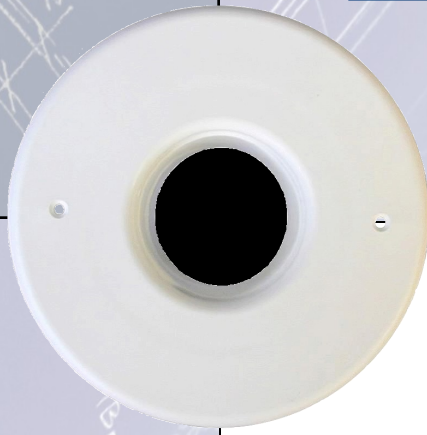

2.5" DUCT WITH THREADED OUTLET



- 2.5" tubing paired with a new threaded outlet
- The 2.5" tubing can quietly deliver up to 50 CFM
- Full range of round and slotted outlets which are available in a variety of finishes
- Has the same sound level as a standard 2" outlet but has more airflow
- If you have normal duct lengths, and can maintain the same static pressure, you can reduce the number of outlets by 20% and save on installation time



DON'T FORGET

- The tubing requires a 4.5" hole saw which Unico can provide... Part # A01478-G05
- Tubing comes in R-4.2, R-6 and R-8
- The 2.5" tubing is to be used with metal plenum only

800-527-0896 www.unicosystem.com
7401 Alabama, St. Louis, MO. 63111



UniSpot
INDUSTRIAL SPOT COOLING

The Unico System[®]
Small-Duct Central Heating & Air Conditioning

UniChiller[®]
HEATS & COOLS AC

The Unico System®

Small-Duct Central Heating & Air Conditioning

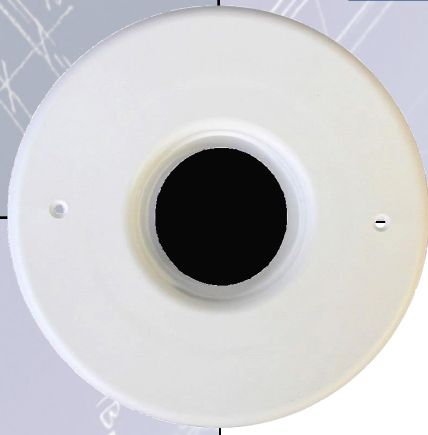

STANDARD 2" DUCT



- Our standard duct can deliver up to 30 CFM
- Full range of round and slotted outlets which are available in a variety of finishes
- Outlets can also be painted to match any color
- Recommended to use 6 outlets per nominal ton to keep noise levels virtually silent

DON'T FORGET

- You can use UPC-55 to cut through fiberglass plenum
- Tubing comes in R-4.2, R-6 and R-8
- Can be used with metal or fiberglass plenum



Round Outlet Dimensions

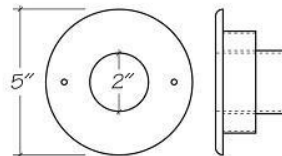

Slotted Outlet Dimensions

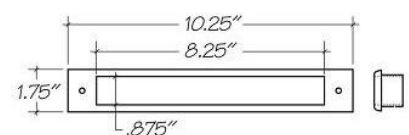

800-527-0896 www.unicosystem.com
7401 Alabama, St. Louis, MO. 63111



UniSpot
INDUSTRIAL SPOT COOLING

The Unico System
Small-Duct Central Heating & Air Conditioning

UniChiller
HEATS & COOLS AC